

TECHNICAL DATA SHEET

SECUMAX 145 NO. 145001

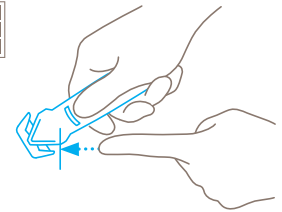

Safety technology



Concealed blade – a maximum degree of safety

The SECUMAX 145 blade is not an open one, but is hidden from people and goods. This provides you with a maximum degree of safety from cut injuries and from damage to goods.



SMALL SAFETY KNIFE WITH CONCEALED BLADE FOR VARIOUS CUTTING MATERIALS.

Order No. 145001.12

Compact design. Sustainable performance.

The SECUMAX 145 is our clever, compact safety knife for routine cutting tasks. The glass-fibre reinforced plastic handle made from recycled plastic (at least 60%) and 0.5 mm strong blade gives it remarkable robustness. At just 12 g it is also extremely light. The disposable cutting tool easily copes with single-layer cardboard, film and packing tape, for example. The two cutting edges are safely concealed to protect fingers.

2-in-1 blade head

The blade head provides two functions: cutting and piercing. Use the knife's noses to the left and right of the blade to effortlessly pierce materials (e.g. card and film), and the blade head's corners for packing tape.

Concealed blade

With a 4 mm blade access, the blade is highly concealed. Out of reach for fingers but accessible to the materials to be cut. And contents under the cutting surface will also be kept safe from contact with the cutting edge.

Flat and robust design

It is not just the handle that has an extremely flat design – the cutting channel only measures 1.5 mm, requiring less effort for cutting. The tool also retains its strength – thanks to a 0.5 mm blade and high-quality, recycled plastic.

Lightweight and sustainable

The SECUMAX 145 is so lightweight that users will hardly notice it. This is aided by the comfortably rounded 4 mm wide handle. Conserving materials is combined with the use of recycled plastic. This means double the environmental sustainability.

Clever guide surfaces

A tip from us on cutting card: hold the blade at an angle to improve cutting! It is no accident that the guide surfaces are located at the front of the knife – they aid cutting at the most effective angle.

USAGE

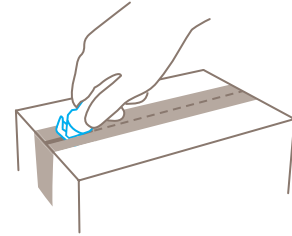
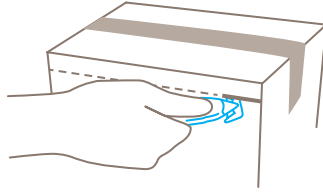
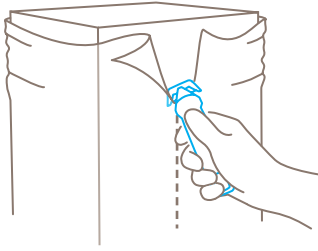

PRODUCT FEATURES

Technical features



Maximum safety



Disposable knife



Abrasion resistant



Ergonomic



2-times usable blade



Cutting depth



For right and left hander



Lanyard hole



Printable for promotional purposes

Main cutting materials



Cardboard: 1-ply



Wrapping, stretch and shrink foil



Tape



Bagged goods



Layers of foil or paper



Yarn, cord



Plastic strapping band

Installed blade

Blade thickness 0.50 mm.

BLADE CHANGE

The blade is moulded into the body of the knife and cannot be changed.

Blade thickness 0.50 mm.

SERVICES OFFERED



Safety poster



Training video



Technical data sheet



Consulting service

PRODUCT AND PACKAGING DETAILS

Order No.	NO. 145001.12	Packaging unit	10 in box (loose)
Knife size (L x W x H)	118 x 4 x 35.4 mm	Size Single unit box	124 x 36 x 42 mm
Weight knife	12.0 g	Weight single unit box	135.0 g
Basic material	Recycled plastic	EAN Code single unit box	4002632800658
Cutting depth	3.8 mm	Customs tariff number	82119200

SAFETY CERTIFICATE

Ausstellungsdatum	05. Januar 2022	Certificates and awards	
Zertifikat	GS-Zertifikat NR. 183031-7333-55094-2021		



SECURITY ADVICE

To ensure that you use your new MARTOR knife safely and most effectively, please read and note the following user instructions. Please keep the written guide in a safe place so that you can access it at any time.

1. Usage advice: Please use the product carefully for described work only and not for any purposes other than those that are intended. Please take the correct handling and the proper use of the cutting tool into account in this regard.

2. Special application Instructions to avoid the danger of injuries: Only use cutting tools that are in perfect condition and have sharp, clean and undamaged blades. Employ the utmost care when handling the knives. CAUTION: The blade is sharp and can result in serious and deep cuts. Therefore, never reach into the blade! To reduce the danger of injuries, hold the hand that is being used to restrain and stabilise the

cutting base in such a manner that the restraining hand or even other body parts are not endangered in the event that the knife slips. Do not modify this product in any way. Modifications of any kind may impair product safety. CAUTION: The risk of injury caused by manipulation of this product is extremely high. When both cutting edges are no longer sharp, dispose of the knife as general waste.

3. Non-use of the knife: Store the knife in a secure place.

4. Care instructions: Always keep the knife clean and do not expose it to unnecessary humidity to safeguard a long service life.

CAUTION: No liability will be assumed for consequential losses. Subject to technical changes and errors! This knife does not belong in the hands of children!

ACCESSORIES

BELT HOLSTER S

NO. 9920



What do you do with your cutting tools when you are not actually using them? The MARTOR BELT HOLSTER S is a robust holder that allows you to carry all compact MARTOR knives as well as our safety scissors at all times. In addition, the compartments are designed to allow you to load different tools: for example you can also carry a pen or a pack of blades. The MARTOR BELT HOLSTER is the ideal place to stow your tools safely when moving from A to B - and have them at hand, as soon as they are required.

BELT HOLSTER XXL

NO. 9924



The BELT HOLSTER XXL is a real space miracle. With it, you not only transport your MARTOR cutting tools safely from A to B. All other work utensils are always within reach. The BELT HOLSTER XXL has two large compartments: the inner one is lockable, the outer one is equipped with a knife safety device. You are also well equipped when it comes to carrying options. Choose flexibly between strap, Velcro fastener and clip.

TOOL RETRACTOR

NO. 9960



The TOOL RETRACTOR protects your cutting tool from loss and from falling down. Its core is the heavy-duty Kevlar cord that can be extended up to 90 cm. As soon as you let go of your knife, it is returned to you via the flexible cord. Your hands are free for other activities – the knife always remains at hand. The carabiner is designed for your belt loop, the steel cord at the other end fits through the eyelet of your cutting tool.



Value Driven Safety

Distributed by: Saurya HSE Pvt Ltd

HO: C-112 A Kailash Business Park, Veer Sawarkar Marg, Vikhroli West, Mumbai 400079, India

T: +91 22 4065 5555 | E: commercial@sauryahse.com | W: sauryahse.com