

SECUPRO MARTEGO  
ALMOST TOO GOOD TO BE TRUE!

NEW



Value Driven Safety



ENJOY SAFETY  
MADE IN SOLINGEN

**martor**

# SECUPRO MARTEGO

NO. 1220019



Original size



#### Perfect handling

The advantages of the SECUPRO MARTEGO lie in your hands. The ergonomic squeeze-grip, the soft grip for better handling, the "pre-set" cutting edge; these three factors guarantee an ergonomic experience.



#### Change safely

When you need to change the blade, you can do so without any additional tools. Press the blade change button and fold the blue lever out all the way to access the blade.

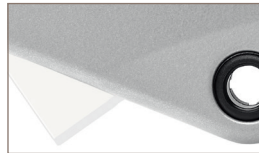

#### Everything under control

It's all about aluminium. The powder-coated metal body doesn't only contribute to the SECUPRO MARTEGO's extraordinary design. It also increases robustness and enables the handle to withstand maximum stress.



#### Blade lock for extra protection

Your SECUPRO MARTEGO accompanies you on your job at every cut and turn? Glad to hear it. But always press the blue blade lock when you've finished cutting! This way the blade cannot make a surprise appearance.



#### 4-cutting edge blade

The quality blade, with its four sharp edges, can be rotated multiple times. It's worth it! In the meantime, a relatively small cutting depth protects your goods from unnecessary damage.

## For highest demands. With ceramic blade.

A cutting tool in which function and design go hand in hand? Meet the SECUPRO MARTEGO, our prize winning squeeze-grip safety knife with fully automatic blade retraction. Get used to the word "very" in its presence: it's very safe, very robust, very ergonomic, very versatile, and made to very high standards. It uses a MARTOR ceramic blade that is extremely sharp and long-lasting.

### Application

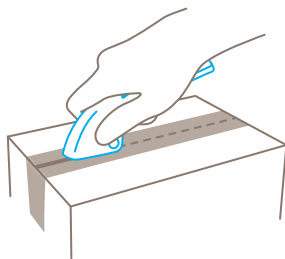
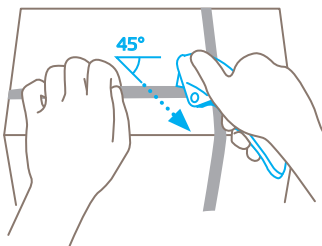
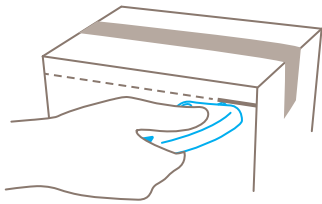

### Safety technology

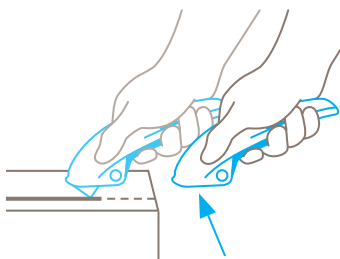

#### Fully automatic blade retraction – a very high degree of safety

The fully automatic blade retraction of the SECUPRO MARTEGO guarantees a very high degree of safety from cut injuries. The blade withdraws into the handle immediately after leaving the material being cut. Even when the lever is still being squeezed.

### PRODUCT FEATURES

#### Technical features



Very high safety



Tool-less blade change



Very abrasion resistant



Very ergonomic



Safety lock



4-cutting edge blade



Cutting depth



Ceramic



Soft grip



For right and left handers



Printable for promotional purposes

#### Main cutting materials



Cardboard: up to 2-ply



Plastic strapping band



Tape



PVC



Wrapping, stretch and shrink foil



Layers of foil or paper

#### Installed blade



**NO. 92C**

0.50 mm, ceramic, deep-edged

#### Optional blade



**NO. 92**

0.40 mm

**NO. 60092**

0.40 mm, rounded blade tips

**NO. 192**

0.40 mm, stainless

#### Certificates and awards







# THE PERFECT FIT FOR ALL. DOES THE PERFECT JOB.

## SECUPRO MARTEGO

- › Ergonomic squeeze-grip
- › With ceramic blade
- › Fully automatic blade retraction
- › Well made and cleverly designed, featuring soft-grip
- › GS-certified for approved safety

## PRODUCT DETAILS

Order No.	NO. 1220019.17		
Packaging unit	1 in single unit box (10 in multipack)		
Knife size (L x W x H)	155 x 18 x 48.5 mm		
Main material	Aluminium		
Weight	104.0 g		
Cutting depth	9 mm		
Spare blade	NO. 1792.25		
Packaging unit	(2 on self-service card)		
Size (L x W x Thickness)	26 x 18.5 x 0.50 mm		
Certified	GS certificate NO. 178906-7058-55094-2020		
Accessories			
BELT HOLSTER M WITH CLIP		NO. 9921	
USED BLADE CONTAINER		NO. 9810	
WALL MOUNT BRACKET USED BLADE CONTAINER		NO. 9845	
SAFEBOX		NO. 108000	



Value Driven Safety

## CONTACT AND SERVICE

What makes our cutting solutions even safer? Our advisory services! We are always on hand, to give advice, to provide you with training material, to meet with you in person if necessary.

You will find further information on our website:

[www.sauryahse.com](http://www.sauryahse.com)



At a glance: the safety poster shows the most important functions and correct usage – perfect for your workplace.



From the first cut to changing the blade, our video will show you the best way to use this knife.



Everything you want to know: dimensions, properties, special features and more about our cutting tools can be found in the Technical Data Sheet.



Still have questions? You can reach our service department on **+91 22 4065 5555**