

SECUNORM 185
EFFICIENT TO CUT. COMFORTABLE TO USE.

SAURYA

Value Driven Safety

NEW

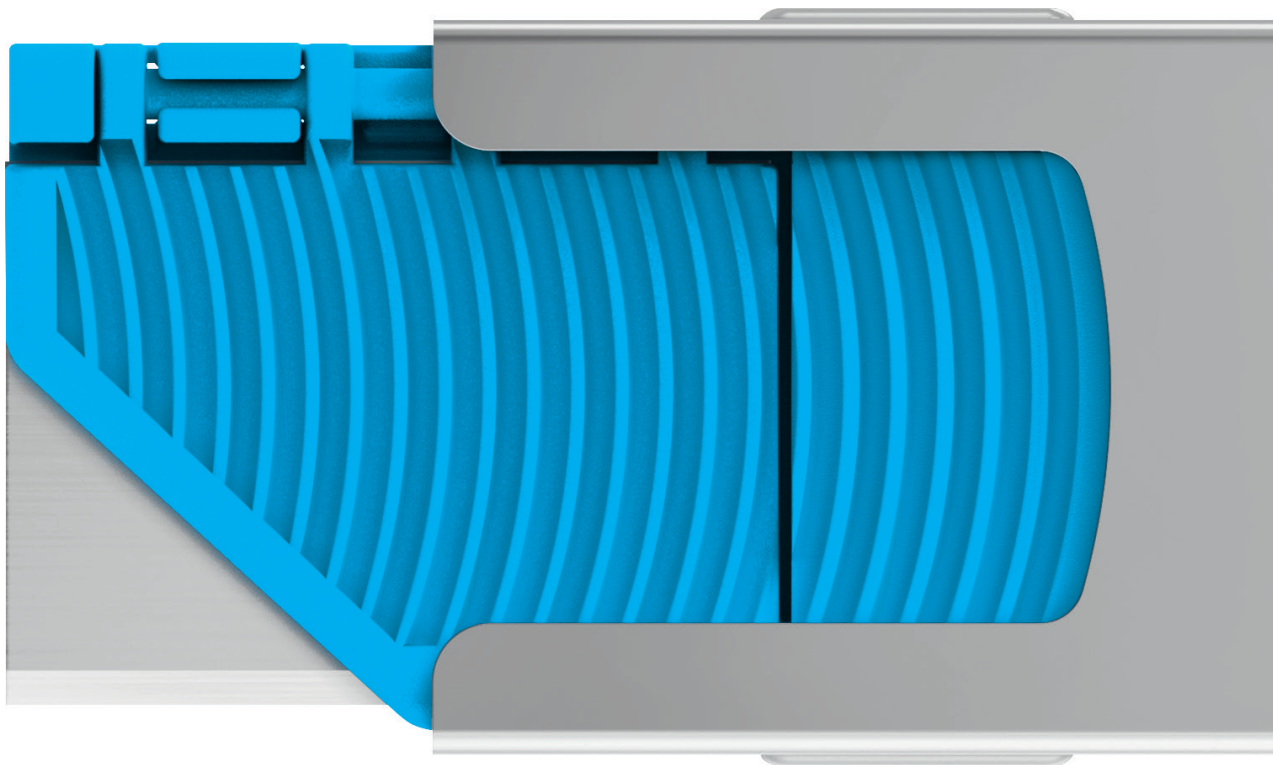

THE SAFER WAY TO CUT.

martor

SECUNORM 185

NO. 18500410



Original size

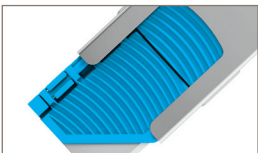

Robust and practical

The SECUNORM 185's handle is made of stainless steel, designed for frequent cutting and long service. The knife has an ergonomic practical format and light-weight design to make cutting easier.

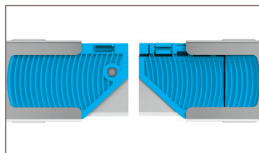

Optimal slider

The double-sided slider is suitable for both right and left handers. It has a large surface for perfect operation even when wearing gloves. Grooves on the slider improve slip resistance.

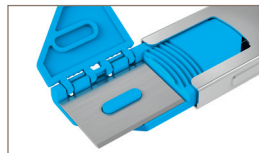

Safe blade change

Simply hold down the blade change button and pull out the slider from the front to give access to the magnet-fixed blade. The plastic insert and handle remain together so that nothing will be lost.



Practical eyelet

The SECUNORM 185 is equipped with an eyelet for attaching a strap, securing the knife to be on hand as soon as the next package needs opening.



4-cutting edge blade

The blade has four cutting edges that can be used one after the other. This makes economic and ecological sense and, with a fresh cutting edge, you can always cut like new.

Option ceramic blade



You can now also use a ceramic blade as an alternative to the installed steel blade. For the SECUNORM 185, this is the CERAMIC BLADE NO. 92C.

Application

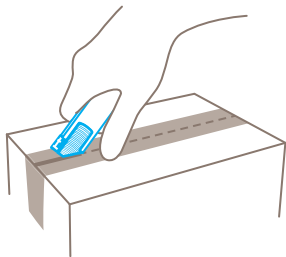
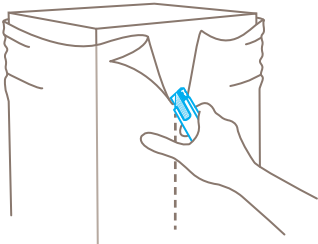
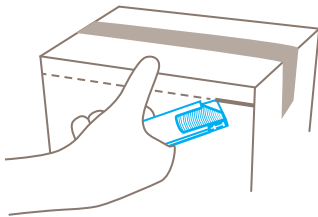

Safety technology

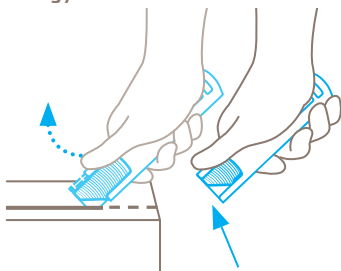

Automatic blade retraction – a high degree of safety





The automatic blade retraction of the SECUNORM 185 guarantees a high degree of safety from cut injuries. As soon as you have started to cut, take your thumb off the slider. Then the blade will retract into the handle immediately after leaving the material being cut.

Lots of knife requiring little space.







Efficiency is important when opening cartons and pallets. Just what the nimble and robust SECUNORM 185 has been designed for. The compact safety knife impresses with features rarely found in this product group, such as a stainless steel handle, a large slider and easy blade change. Other benefits are the automatic blade retraction and a choice between steel and ceramic blades.

PRODUCT FEATURES

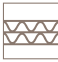
Technical features

 High safety	 Safer blade change (with magnet)
 Abrasion resistant	 Ergonomic
 4-cutting edge blade	 Cutting depth
 Ceramic blade compatible	 For right and left handers
 Lanyard hole	

Main cutting materials

 Cardboard: up to 2-ply	 Wrapping, stretch and shrink foil
 Tape	 Plastic strapping band
 Layers of foil or paper	 Yarn, cord

Installed blade

	NO. 92	0.40 mm
--------------------------------------------------------------------------------------	---------------	---------

Optional blade

	NO. 192	0.40 mm, stainless
	NO. 92C	0.50 mm, ceramic, deep-edged
	NO. 60092	0.40 mm, rounded blade tips
	NO. 92043	0.40 mm, deep-edged
	NO. 192043	0.40 mm, deep-edged, stainless

Certificates and awards







YOU CAN FEEL THE QUALITY.

SECUNORM 185

- › Robust, stainless steel handle made of metal
- › Small and handy
- › One blade, four cutting corners
- › Automatic blade retraction
- › GS-certified for approved safety

PRODUCT DETAILS

Order No.	NO. 18500410.02
Packaging unit	1 in single unit box (20 in multipack)
Knife size (L x W x H)	102 x 26 x 7.2 mm
Main material	Stainless steel
Weight	32.0 g
Cutting depth	9 mm
Spare blade Packaging unit Size (L x W x Thickness)	NO. 92.66 (10 in safety dispenser) 26 x 18.5 x 0.40 mm
Certified	GS certificate NO. 180823-7255-55094- 2021
Accessories	
BELT HOLSTER S WITH CLIP	 NO. 9920
SAFEBOX	 NO. 108000
USED BLADE CONTAINER	 NO. 9810
WALL MOUNT BRACKET USED BLADE CONTAINER	 NO. 9845

CONTACT AND SERVICE

What makes our cutting solutions even safer? Our advisory services! We are always on hand, to give advice, to provide you with training material, to meet with you in person if necessary.

You will find further information on our website: www.martor.com



At a glance: the safety poster shows the most important functions and correct usage – perfect for your workplace.



Everything you want to know: dimensions, properties, special features and more about our cutting tools can be found in the technical data sheet.



Still have questions? You can reach our service department on [+49 212 73870-0](tel:+49212738700)

Distributed By:
SAURYA HSE PVT LTD
C-112A, Kailash Business Park, Veer Sawarkar Marg,
Vikhroli (West), Mumbai – 400079, Maharashtra, India
T: +91 22 4065 5555 | E: commercial@sauryahse.com