

TECHNICAL DATA SHEET

SECUNORM PROFI25 MDP NO. 120701

Safety technology

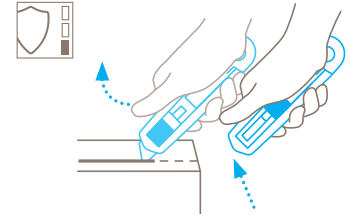

Automatic blade retraction – a high degree of safety

The automatic blade retraction of the SECUNORM PROFI25 MDP guarantees a high degree of safety from cut injuries. As soon as you have started to cut, take your thumb off the slider. Then the blade will retract into the handle immediately after leaving the material being cut.



ROBUST SAFETY KNIFE WITH AN EXTENDED BLADE LENGTH OF 25 MM AND AUTOMATIC BLADE RETRACTION.

Order No. 120701.02

Professional in every respect. Metal detectable. With rounded-tip trapezoid blade.

Our SECUNORM PROFI25 MDP is aptly named. "PROFI" because this safety knife really does behave professionally. Whatever the situation, whatever the cutting material. The "25" is in reference to its impressive blade extension of 25 mm, with which even 3-ply cardboard can be cut. And finally, the "MDP" tag means that all plastic parts of this knife can be detected by a metal detector.

Metal detectable

While working, a cutting tool – or parts of it – can sometimes get lost. But only for a short while. Because the plastic that can be detected by a metal detector ensures that you find it again fast.

No paint

You would like to avoid risks in your job, wherever possible? That's understandable. An unpainted handle minimises the risk of contamination of the production process.

Robust handle

The plastic insert of the SECUNORM PROFI25 MDP is in an aluminium handle. With its robust design, it is predestined for high cutting frequencies and a long life.

2-cutting edge blade

Before you have to change the quality blade, you can turn it around once. This doubles the usage time of the blade – and reduces the energy you use up. Because your product cuts like new again.





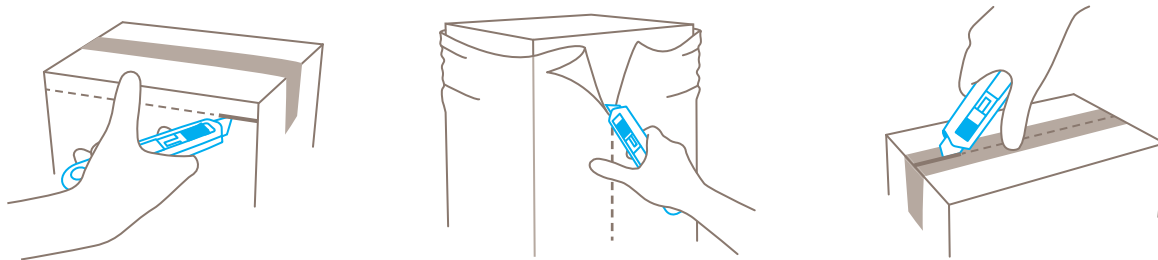





Tool-less blade change

Blade changing is quick to work out. Literally. You just need to slide the metal detectable plastic insert out of the handle and replace the old blade with a new one.













PRODUCT FEATURES

Technical features

 High safety	 Metal detectable	 X-ray detectable	 Tool-less blade change
 Very abrasion resistant	 Very ergonomic	 2-cutting edge blade	 Cutting depth
 Rounded-tip trapezoid blade	 For right and left handers	 INOX	

Main cutting materials

 Cardboard: up to 3-ply	 Wrapping, stretch and shrink foil	 Plastic strapping band	 Tape
 Bagged goods	 Layers of foil or paper	 Yarn, cord	 PVC
 Fleece	 Felt	 Textile, material	

Installed blade



NO. 160099
0.63 mm, rounded blade tips, deep-edged, stainless

Optional blade



NO. 199
0.63 mm, deep-edged, stainless

BLADE CHANGE

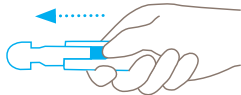

Use the slider to **push** the plastic insert back and out of the handle. Don't pull the insert while holding onto the slider.

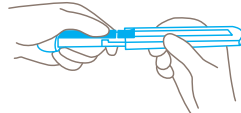

When the slider and blade exits the handle, position your **index finger under the black blade holder** to hold it tight.

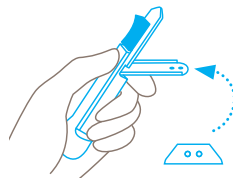

Use your index finger to slowly **fold out the blade holder downwards**. Use the other hand to remove the blade to either replace it or turn it around (for left handers).

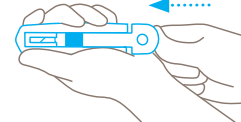

Make sure you position the blade **exactly over the locating lugs**, close the blade holder upwards. **Attention:** Never hold your hand in front of the blade exit!

SERVICES OFFERED



Safety poster



Technical data sheet



Consulting service

PRODUCT AND PACKAGING DETAILS

Order No.	NO. 120701.02	Packaging unit	1 in single unit box
Knife size (L x W x H)	143 x 17 x 31 mm	Size Single unit box	144 x 22 x 38 mm
Weight knife	84.5 g	Weight single unit box	99.3 g
Basic material	Aluminium	EAN Code single unit box	4002632803741
Cutting depth	18 mm	Quantity in outer pack	10 knives
		Size outer pack	115 x 80 x 160 mm
		Weight outer pack	1037.2 g
		EAN Code outer pack	4002632853746
		Customs tariff number	82119300

SAFETY CERTIFICATE

Date of issue	12.05.2020
Certification	GS certificate NO. 179404-7116-55094-2020/2

Certificates and awards



SAFETY ADVICE

To ensure that you use your new MARTOR knife safely and most effectively, please read and note the following user-instructions. Please keep the written guide in a safe place so that you can access it at any time.

1. General application instructions: Please always use the product carefully for manual cutting work only and not for any purposes other than those that are intended. Please take the correct handling and the proper use of the knives into account in this regard. As an additional safety measure, we recommend the wearing of safe gloves.

2. Special application instructions to avoid the danger of injuries: Always take great care when handling the product. Before first use, familiarise yourself with the safety technology and how it works. Before every further use, check the knife for proper functioning. Only use cutting tools that are in perfect condition with sharp, clean and undamaged MARTOR blades. Also make sure that the knife's operation is not impaired by the material to be cut or by dirt or particle deposits around the blade. **CAUTION: The blade is sharp and can result in serious and deep cuts. Therefore, never reach into the blade!** Do not place your free hand in the line of cutting and never cut directly towards you.

3. Replacement of spare parts: Replace any blades that become dull at the right time! Use only the replacement blades from MARTOR for this purpose. Dispose of old blades in a proper fashion. They should not be placed in a waste paper bin, as this poses a considerable danger of injuries. Never perform any repairs yourself. If the knife shows signs of aging or any other wear, e.g. which impair safety features, blade changing or usage, the knife must be taken out of service and replaced. Do not modify this product in any way. Modifications of any kind may impair product safety. **CAUTION:** The risk of injury caused by manipulation of this product is extremely high.

4. Non-use of the knife: Always secure the blade in such a way (depending on product type) that injuries due to cuts are excluded. Store the knife in a secure place.

5. Care instructions: To guarantee a long service life, always keep the knife clean and do not expose it to unnecessary soiling and humidity.

CAUTION: No liability will be assumed for consequential losses. Subject to technical changes and errors! This knife does not belong in the hands of children!

ACCESSORIES

BELT HOLSTER S WITH CLIP NO. 9920



What do you do with your cutting tools when you are not actually using them? The MARTOR BELT HOLSTER S is a robust holder that allows you to carry all compact MARTOR knives as well as our safety scissors at all times. In addition, the compartments are designed to allow you to load different tools: for example you can also carry a pen or a pack of blades. The MARTOR BELT HOLSTER is the ideal place to stow your tools safely when moving from A to B - and have them at hand, as soon as they are required.

HOLSTER SMALL NO. 9842



This blue plastic HOLSTER is just like the black version, only smaller. Use it to safely store and transport for example for the SECUNORM 500 or the SECUNORM 300. With this HOLSTER on your hip, your knife will always be within grasping range.

USED BLADE CONTAINER NO. 9810



You can fill the USED BLADE CONTAINER with the content of your SAFEBOX. Or directly with your used blades. When the box is full, turn the lid until it shuts. Now the box cannot be reopened. The next step is to safely and completely dispose of the filled USED BLADE CONTAINER as normal waste.

WALL MOUNT BRACKET USED BLADE CONTAINER NO. 9845

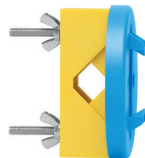

Include it in your order now! With this mounting bracket you can fix your USED BLADE CONTAINER to a central location. Use the clamp and screws and nuts supplied with the product to attach it to either a pipe or a rod.

SAFEBOX NO. 108000



The SAFEBOX is large enough to store a large number of used blades safely. And at the same time, it is compact enough to carry with you. The two slits are not only used for filling, but also to "shorten" your snap-off blades. When your SAFEBOX is full, empty it into your USED BLADE CONTAINER.

MDP TEST CARD SET NO. 9910



There are five cards with different plastic balls in the MDP TEST CARD SET – between 2.5 mm and 8 mm in size. You can reliably test the effectiveness of your metal detectors using the "visiting card".

MANUFACTURER

MARTOR KG | Lindgesfeld 28 | 42653 Solingen | Germany
T +49 212 73870-0 | info@martor.de | www.martor.com