

## TECHNICAL DATA SHEET

### GRAPHIC BLADE NO. 8606



GRAPHIC BLADE NO. 8606 from MARTOR is a high-quality blade made of steel with TiN-coating. It is very sharp and has one usable cutting edge. Rounded tips increase user safety. The blade is 31.1 mm long, 5.7 mm wide and 0.50 mm thick.

GRAPHIC BLADE NO. 8606 is available under order number 8606.65 in a safety dispenser of 100.

#### PRODUCT DETAILS

Order No.	NO. 8606.65
Blade size (L x W)	31.1 x 5.7 mm
Material thickness	0.50 mm
Weight Blade	0.5 g
Basic material	Steel
Refinement/ Version	TiN
Ground	2-sided ground-edge
Blade facets	Double bevel edge-ground
Safety feature	rounded blade tip
Blade characteristics	1-cutting edge blade

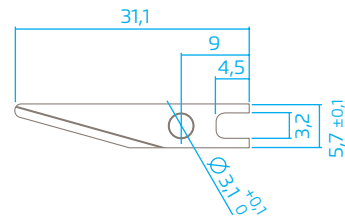

#### PACKAGING DETAILS

Packaging unit (PU)	100 in safety dispenser
Size PU	67 x 41 x 12 mm
Weight PU	53.5 g
EAN Code PU	4002632918490
Quantity in outer pack	10 safety-dispensers
Size outer pack	117 x 42 x 82 mm
Weight outer pack	600 g
EAN Code outer pack	4002632969812
Customs tariff number	82141000

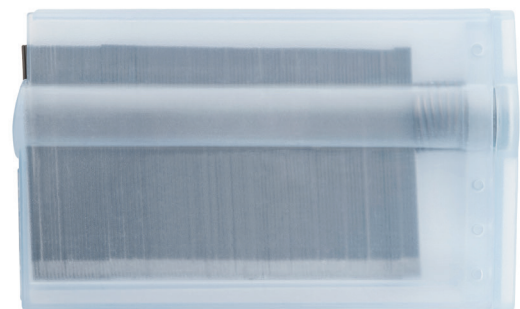

#### PRODUCT FEATURES

##### Technical features



Rounded-tip scalpel blade



TiN-coated



2-sided ground-edge

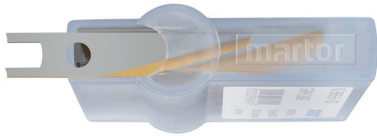

## MOUNTABLE IN

---

The blade can be used in the following MARTOR knives: GRAFIX 501, TRIMMEX CUTTOGRAF.

## SAFETY ADVICE

---



**CAUTION: The blade is sharp and can result in serious and deep cuts. Therefore, never reach into the blade!**

Only use cutting tools that are in perfect condition with sharp, clean and undamaged MARTOR blades. Also make sure that the knife's operation is not impaired by the material to be cut or by dirt or particle deposits around the blade.

**1. Replacement of spare parts:** Replace any blades that become dull at the right time! Dispose of old blades in a proper fashion. They should not be placed in a waste paper bin, as this poses a considerable danger of injuries.

**2. Non-use of the knife:** Always secure the blade in such a way (depending on product type) that injuries due to cuts are excluded. Store the knife in a secure place.

**3. Care instructions:** To guarantee a long service life, always keep the knife clean and do not expose it to unnecessary soiling and humidity.

**CAUTION: No liability will be assumed for consequential losses. Subject to technical changes and errors! This knife does not belong in the hands of children!**



Value Driven Safety

Distributed by: Saurya HSE Pvt Ltd  
C-112A Kailash Business Park, Veer Sawarkar Marg, Vikhroli West, Mumbai 400079, India  
T: +91 22 4065 5555 | E: commercial@sauryahse.com | W: sauryahse.com