

COPPUS Portavent®

Versatile centrifugal ventilator for
source capture fume exhaust

MODEL/SPECIFICATIONS

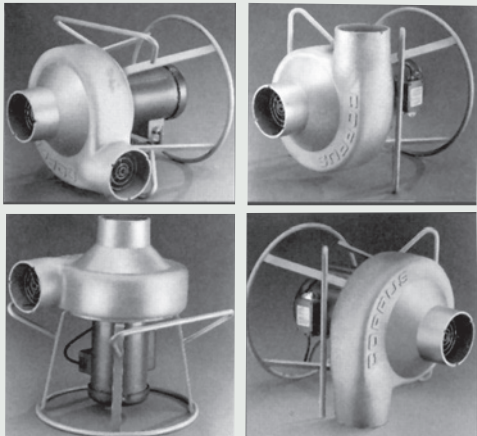

Unique stand design offers multiple set-up options.

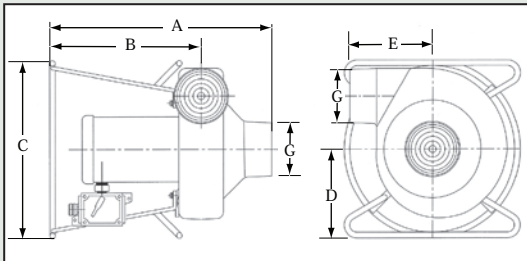

DESCRIPTION

The design, performance and versatility of the PORTAVENT centrifugal ventilator make it ideal for a wide range of industrial applications—welding and other fume removal; small tank purging; equipment cooling; confined space ventilation; and other maintenance and safety applications.

NOTE: PV-500 & PV-750 special order only.

FEATURES / ADVANTAGES

- Available in three models offering 560 to 940 cfm (951 to 1,597 m³/hr)
- Direct-drive 3,500 RPM fan motor
- Cast aluminum fan and housing provide spark-resistant construction
- Unique, multi-position stand offers a variety of convenient set-ups
- Accepts flexible duct at inlet and outlet ends
- Backwardly inclined airfoil blades prevent motor overloads
- Inlet and outlet screens meet OSHA standards
- TE and EP motors available on all models



DIMENSIONS

MODEL	in/mm						
	A	B	C	D	E	F	G
PV-1000	22.9 582	15.6 396	19.0 483	9.5 241	9.3 236	5.9 150	5.9 150

TECHNICAL DATA

AIR FLOW THROUGH FLEXIBLE DUCT (STRAIGHT RUNS)													
MODEL	50 Hz	Free Air		10 ft 3.05 m		20 ft 6.10 m		30 ft 9.15 m		50 ft 15.25 m		Duct Size	
		cfm	m ³ /hr	cfm	m ³ /hr	cfm	m ³ /hr	cfm	m ³ /hr	cfm	m ³ /hr	in	mm
		PV-1000	783	1,331	661	1,124	631	1,072	607	1,032	566	962	6.0

FREE AIR DECIBEL LEVELS

PV-1000	90 dBA
---------	--------