

SECUMAX 350

VERSATILE, COMFORTABLE, SAFE? VERY SAFE!

SAURYA

Value Driven Safety



ENJOY SAFETY  
MADE IN SOLINGEN

**martor**

# SECUMAX 350

NO. 350001



Original size



#### 2-in-1 blade head

Double function, doubly useful: with two cutting edges and two tape splitters, this multifunctional blade head exceeds itself. Before you need to change the blade, flip it over once to use the second side.



#### Concealed blade

The SECUMAX 350 is a smart cutter. It's fitted with an double-sided overmoulded blade, the noses have the perfect length to protect. The two cutting edges are wide enough to safely and effortlessly cut 2-ply cardboard.



#### Spare blade in storage

Blade change is easily and safely executed. Look for the arrow and follow its lead. Open the blue inner side of the cutter to reveal the spare blade. The mounted blade will simultaneously unlatch.



#### Light and easy

A cutting heavyweight, but with only 37 grams, this cutter is rather lightweight... Meaning that even high cutting frequencies won't weigh you down. There's no need to stress when handling the blade either: a plastic jacket protects your fingers.



#### Ergonomically shaped

Right handed or left handed? It's really all the same. The SECUMAX 350 fits perfectly in any hand. Gently arching outer edges, coupled with suitably located soft-grip and light ribbing make for an ergonomic experience.

## More fun while you work? Try it out.

The new SECUMAX 350 is a combination of versatility, comfort and safety. A maximum degree of safety. Featuring an innovative blade change, this cutter is multi-talented. It can be used to cut all standard materials, from film to plastic-straping, from paper to 2-ply cardboard. It splits adhesive tape easily too. And it is so comfortable to hold that you won't want to put it down.

### Application

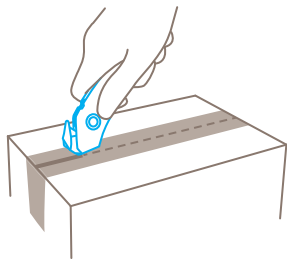
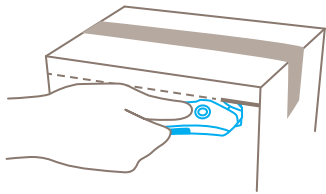
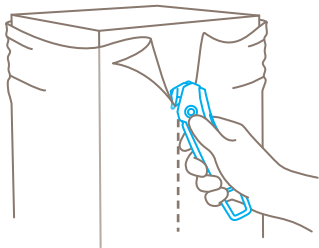

### Safety technology

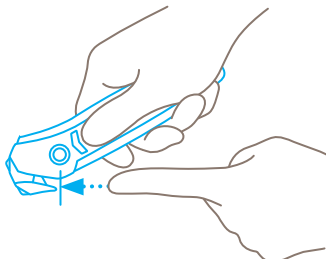

#### Concealed blade – a maximum degree of safety



The SECUMAX 350 blade is not an open one, but is hidden from people and goods. This provides you with a maximum degree of safety from cut injuries and from damage to goods.

### PRODUCT FEATURES

#### Technical features

	Maximum safety		Tool-less blade change
	Abrasion resistant		Very ergonomic
	2-times usable blade		1 spare blade in knife body
	Cutting depth		Tape splitter
	Soft-grip		For right and left hander
	Lanyard hole		Printable for promotional purposes

#### Main cutting materials

	Cardboard: up to 2-ply		Wrapping, stretch, and shrink foil
	Tape		Plastic strapping band
	Bagged goods		Layers of foil or paper

#### Installed blade



NO. 3550 0.30 mm

#### Certificates and awards



YOU CAN FEEL THE QUALITY.



## SECUMAX 350

- › Ideal for cutting and splitting
- › Concealed blade
- › Spare blade in storage
- › Ergonomic shape including soft grip
- › TÜV-certified

## PRODUCT DETAILS

<b>Order No.</b>	NO. 350001.02
<b>Packaging unit</b>	1 in single unit box (10 in multipack)
<b>Knife size (L x W x H)</b>	154 x 12 x 40 mm
<b>Main material</b>	Glass fibre reinforced plastic
<b>Weight</b>	37.0 g
<b>Cutting depth</b>	6 mm
<b>Spare blade Packaging unit</b>	NO. 3550.21 (10 in box on self-service card)
<b>Size (L x W x Thickness)</b>	38.9 x 25.8 x 0.30 mm
<b>Certified</b>	GS certificate NO. S 60082479

## Accessories

GÜRTELTASCHE S MIT CLIP		NO. 9920
SAMMELBOX		NO. 9810
WANDHALTERUNG SAMMELBOX		NO. 9845



Value Driven Safety

## CONTACT AND SERVICE

What makes our cutting solutions even safer? Our advisory services! We are always on hand, to give advice, to provide you with training material, to meet with you in person if necessary.

You will find further information on our website:

[www.sauryahse.com](http://www.sauryahse.com)



At a glance: the safety poster shows the most important functions and correct usage – perfect for your workplace.



From the first cut to changing the blade, our video will show you the best way to use this knife.



Everything you want to know: dimensions, properties, special features and more about our cutting tools can be found in the Technical Data Sheet.



Still have questions? You can reach our service department on [+91 22 4065 5555](tel:+912240655555)