

SECUMAX 145

YOUR WORK HAS NEVER BEEN SO EASY.

SAURYA

Value Driven Safety



ENJOY SAFETY  
MADE IN SOLINGEN

**martor**

# SECUMAX 145

NO. 145001

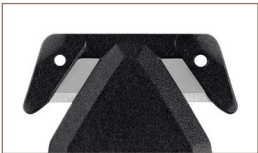

#### 2 in 1 blade head

The blade head provides two functions: cutting and piercing. Use the knife's noses to the left and right of the blade to effortlessly pierce materials (e.g. card and film), and the blade head's corners for packing tape.



#### Concealed blade

With a 4 mm blade access, the blade is highly concealed. Out of reach for fingers but accessible to the materials to be cut. And contents under the cutting surface will also be kept safe from contact with the cutting edge.



#### Flat and robust design

It is not just the handle that has an extremely flat design – the cutting channel too measures just 1.5 mm, requiring less effort for cutting. The tool also retains its strength – thanks to a 0.5 mm blade and high-quality plastic.



#### Light and easy

The SECUMAX 145 is so lightweight that users will hardly notice it. This is aided by the comfortably rounded handle at just 4 mm wide, and thumbs will intuitively find their place at the ergonomically designed grooves.



#### Clever guide surfaces

A tip from us on cutting card: hold the blade at an angle to improve cutting! It is no accident that the guide surfaces are located at the front of the knife – they aid cutting at the most effective angle.

## Compact design. Powerful performance.

The SECUMAX 145 is our clever, compact safety knife for routine cutting tasks. The glass-fibre reinforced plastic handle and 0.5 mm strong blade gives it remarkable robustness. At just 12 g it is also extremely light. The disposable cutting tool easily copes with single-layer cardboard, film and packing tape, for example. The two cutting edges are safely concealed to protect fingers.

## PRODUCT FEATURES

### Technical features

	Maximum safety		Disposable knife
	Abrasion resistant		Ergonomic
	2-times usable blade		Cutting depth
	For right and left hander		Lanyard hole
	Printable for promotional purposes		

### Main cutting materials

	Cardboard: 1-ply		Wrapping, stretch, and shrink foil
	Tape		Bagged goods
	Layers of foil or paper		Yarn, cord

### Installed blade

» The blade is moulded into the body of the knife and cannot be changed. Blade thickness 0.5 mm.

### Application

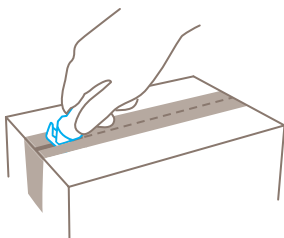
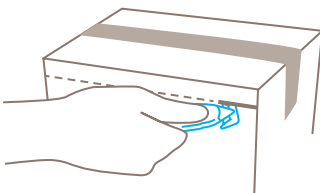
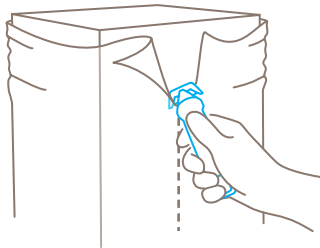

### Safety technology

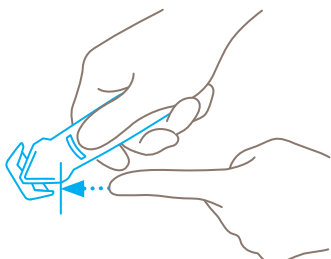

#### Concealed blade – a maximum degree of safety

The SECUMAX 145 blade is not an open one, but is hidden from people and goods. This provides you with a maximum degree of safety from cut injuries and from damage to goods.

### Certificates and awards



YOU CAN FEEL THE QUALITY.

#### SECUMAX 145

- › Concealed blade
- › Practical 2 in 1 blade head
- › Ergonomically shaped handle
- › For everyday cutting tasks
- › GS-certified for approved safety

#### PRODUCT DETAILS

<b>Order No.</b>	NO. 145001.12
<b>Packaging unit</b>	10 in box (loose)
<b>Knife size (L x W x H)</b>	118 x 4 x 35.4 mm
<b>Main material</b>	Glass fibre reinforced plastic
<b>Weight</b>	12.0 g
<b>Cutting depth</b>	3.8 mm
<b>Certified</b>	GS certificate NO. 602578-6075-55094- 2016 C
<b>Accessories</b>	
BELT HOLSTER S WITH CLIP	 NO. 9920



Value Driven Safety

#### CONTACT AND SERVICE

What makes our cutting solutions even safer? Our advisory services! We are always on hand, to give advice, to provide you with training material, to meet with you in person if necessary.

You will find further information on our website:

[www.sauryahse.com](http://www.sauryahse.com)



At a glance: the safety poster shows the most important functions and correct usage – perfect for your workplace.



From the first cut to changing the blade, our video will show you the best way to use this knife.



Everything you want to know: dimensions, properties, special features and more about our cutting tools can be found in the Technical Data Sheet.



Still have questions? You can reach our service department on [+91 22 4065 5555](tel:+912240655555)

Distributed by: Saurya HSE Pvt Ltd  
HO: C-112 A Kailash Business Park,  
Veer Sawarkar Marg, Vikhroli West, Mumbai 400079, India  
T: +91 22 4065 5555 | E: [commercial@sauryahse.com](mailto:commercial@sauryahse.com) | W: [sauryahse.com](http://sauryahse.com)